



# INSTALLATION INSTRUCTIONS

## 57-2535

### Ford

1995-97 Ranger

L4-2.3L Manual trans only

### Mazda

1995-97 B2300

L4-2.3L Manual trans only

**NOTE:** This kit was not designed to fit vehicles with a body lift.

#### TOOLS NEEDED:

- Flat blade screwdriver
- Ratchet
- Extension
- 8mm socket
- 10mm socket
- 13mm socket
- 5mm Allen
- 4.5mm Allen
- 5/8 wrench
- Pliers

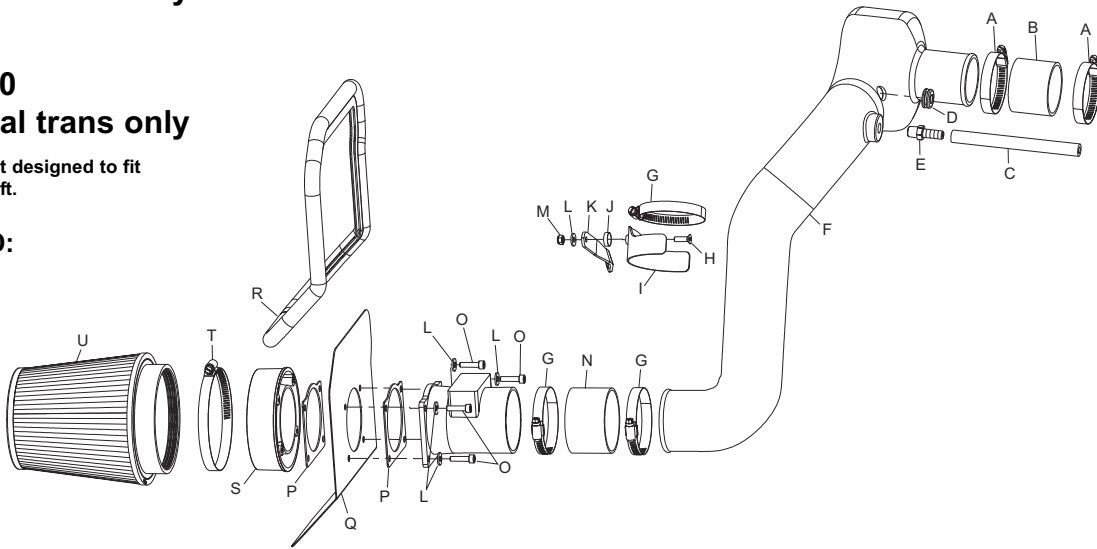

#### PARTS LIST:

Description	Qty.	P/N
A Hose clamp #40	2	08554
B Silicone hose, 2-3/8"IDx2"L	1	08405
C Silicone hose, 8mm IDx6-1/2"L	1	084020
D Grommet; .687"od	1	08092
E .250" NPT by .250"	1	08047
F Intake tube (CC)	1	087051
G Hose clamp #44	3	08577
H Bolt; 6mm-1.00x20mm f/h/a ss	1	08376
I Saddle bracket	1	078855
J Washer, conical, nylon black	1	08180
K Bracket	1	07136
L Washer; 1/4"idx5/8"od	5	08275
M Nut; 6mm nylock hexhead	1	07553
N Silicone hose, 3" id x 2"L	1	08711
O Bolt; 6mm-1.00 x 25mm allen	4	07859
P Mass air gasket	2	09202
Q Heat shield	1	07467
R Edge trim 35"L	1	102471
S Radius adaptor	1	21510
T Hose clamp #80	1	08694
U Filtercharger	1	RF-1037

#### TO START:

1. Turn the ignition OFF and disconnect the vehicle's negative battery cable.



2. Disconnect the air temp. electrical sensor as shown.



3. Remove the crank case vent from the intake tube as shown.



4. Disconnect the mass air electrical connection as shown.



5. Disconnect the mass air wiring loom from the intake tube as shown.

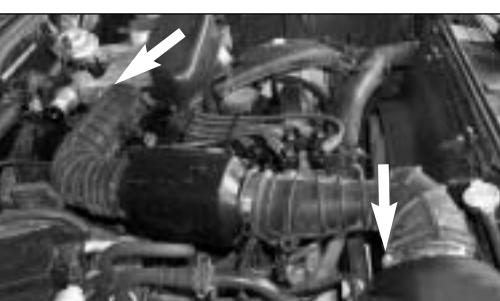

6. Loosen the two hose clamps at the throttle body and air box.



7. Remove the intake tube as shown.

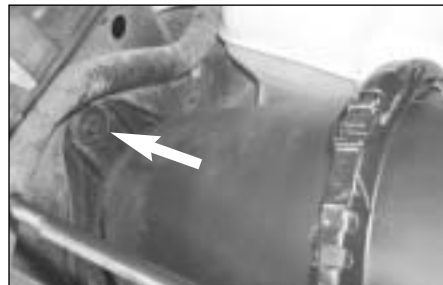

8. Release the push clip that secures the air box onto the vehicle.



9. Pull firmly up on the air box to remove from vehicle.



10. Install the provided grommet into the new K&N intake tube as shown.

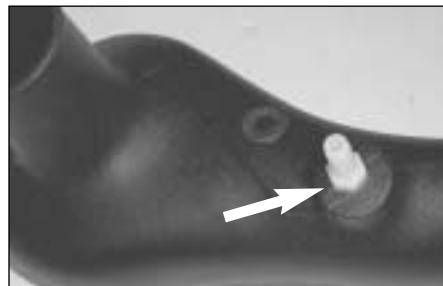

11. Install the vent fitting into the K&N intake tube as shown.



12. Install the provided silicone hose onto the throttle body with the provided hose clamps.



13. Assemble the saddle bracket onto the provided bracket as shown.



14. Remove the bolt that retains the alternator onto the motor.



15. Install the saddle bracket assembly onto the alternator with the bolt that was removed in the previous step.



16. Remove the two bolts that retain the air box mounting bracket to the vehicle then remove bracket from vehicle.

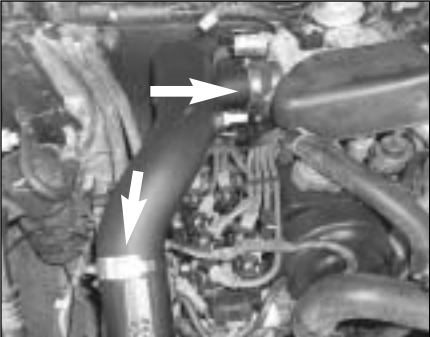

17. Install the new K&N intake tube onto the vehicle and then tighten the provided hose clamps at the throttle body and saddle bracket.



18. Remove the air temp. sensor from the stock intake tube as shown.



19. Install the air temp. sensor into the new K&N intake tube as shown.



20. Reconnect the air temp. electrical connection as shown.



21. Remove the crank case vent hose from the valve cover as shown.



22. Connect the new silicone hose onto the valve cover and intake tube as shown.



23. Open the air cleaner assembly and isolate the mass air sensor assembly.



24. Slide the rubber grommet back and disconnect the primary mass air sensor electrical connection, using a flat blade screwdriver.



25. Using a flat blade screwdriver, push in and release the four clips that retain the mass air sensor retaining plate.



26. Using a pair of small vise grips or pliers, hold the stud while using a 10mm wrench to loosen the nuts, then remove the mass air sensor from the retaining plate.



27. Assemble the heat shield and filter adapter onto the mass air sensor with the provided hardware.



28. Install the edge trim onto the heat shield as shown. Trim if needed.



29. Install the silicone hose onto the mass air sensor with the provided hose clamps.

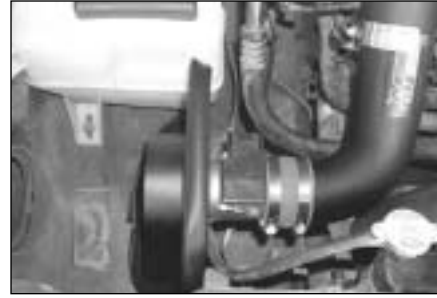

30. Install the mass air assembly onto the new intake tube then tighten the hose clamp.



31. Install the K&N Filtercharger onto the mass air assembly as shown.



32. Connect the mass air pigtail to the main wire loom as shown.



33. Reconnect the mass air electrical sensor as shown.



34. Reconnect the vehicle's negative battery cable. Double check to make sure everything is tight and properly positioned before starting the vehicle.

35. The C.A.R.B. exemption sticker, (attached), must be visible under the hood so that an emissions inspector can see it when the vehicle is required to be tested for emissions. California requires testing every two years, other states may vary.

36. It will be necessary for all FIPK's to be checked periodically for realignment, clearance and tightening of all connections. Failure to follow the above instructions or proper maintenance may void warranty.

### ROAD TESTING:

1. Start the engine with the transmission in neutral or park, and the parking brake engaged. Listen for air leaks or odd noises. For air leaks secure hoses and connections. For odd noises, find cause and repair before proceeding. This kit will function identically to the factory system except for being louder and much more responsive.

2. Test drive the vehicle. Listen for odd noises or rattles and fix as necessary.

3. If road test is fine, you can now enjoy the added power and performance from your kit.

4. K&N suggests checking the Filtercharger element periodically for excessive dirt build-up. When the element becomes covered in dirt (or once a year), service it according to the instructions on the Recharger service kit that is included in this kit.