

**INSTALLATION INSTRUCTIONS**

**77-9016  
TOYOTA  
TACOMA  
2000-04 L4-2.4L, 2.7L  
4RUNNER  
2000 L4-2.7L**

NOTE: This kit was not designed to fit vehicles with a body lift.

**TOOLS NEEDED:**

- Ratchet
- Extension
- 10mm Socket
- 12mm Socket
- 13mm Socket
- Flat Blade Screwdriver
- 10mm Wrench
- 12mm Wrench
- 9/64" Allen Wrench

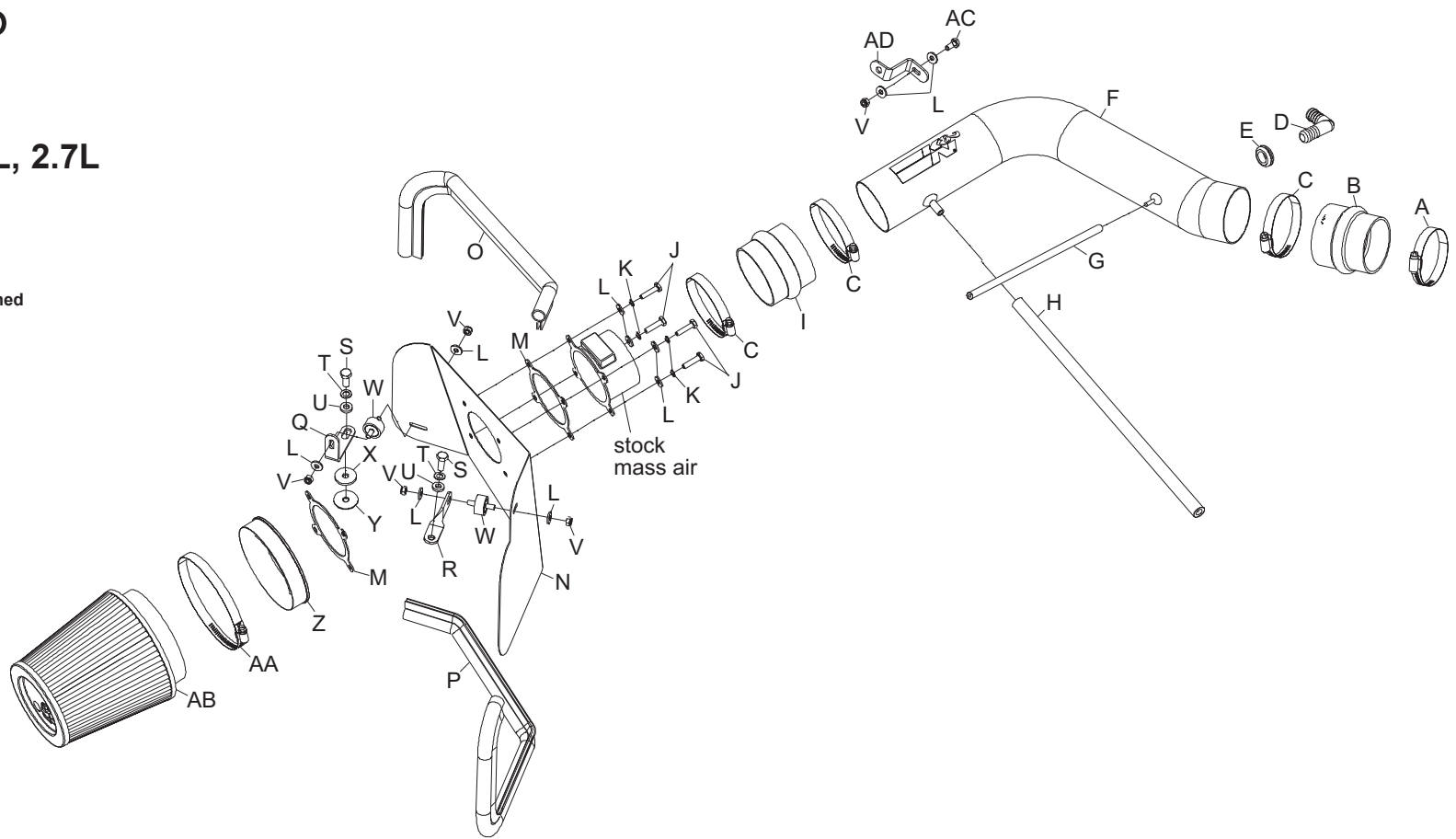

**PARTS LIST:**

Desc.	Qty.	Part #	Desc.	Qty.	Part #	Desc.	Qty.	Part #
A hose clamp #300	1	084062	I hose; 3" id x 3" l, hump	1	08432	Q bracket; "L"	1	26607
B hose; 2-3/4" id to 3" id x 3" l, hump	1	084044	J bolt; 6mm-1.00 x 20mm hex	4	07865	R bracket; twist	1	26606
C hose clamp #325	3	084063	K washer; 1/4" id split lock	4	08198	S bolt; 8mm-1.25 x 20mm hex	2	07787
D vent; 90 deg, 5/8" x 5/8" barb	1	08072	L washer; 1/4" id x 5/8" od flat	10	08275	T washer; 8mm wave	2	08239
E grommet; 1-1/8" od, 5/8" id, 3/8" thk	1	080601	M gasket; mass air sensor	2	09040	U washer; 5/16" id x 5/8" od flat	2	08276
F intake tube	1	27177	N heat shield	1	07448	V nut; 6mm nylock	5	07553
G hose; 4mm id x 12" l, silicone	1	08147	O edge trim 20"	1	102494	W stud; rubber mounted	2	07028
H hose; 3/8" id x 17" l, silicone	1	08404	P edge trim 26"	1	102488	X fender washer	1	08130
						Y rubber washer	1	21708
						Z filter adapter #230	1	08781
						AA hose clamp #80	1	08694
						AB filter charger	1	RF-1037
						AC bolt; 6mm-1.00 x 16mm hex	1	07703
						AD bracket; "Z"	1	07958

**TO START:**

1. Turn the ignition OFF and disconnect the vehicle's negative battery cable.

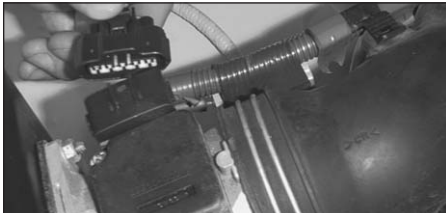

2. Disconnect the mass air sensor electrical connection.



3. Loosen the two hose clamps on the intake hose and remove the intake hose as shown.



4. Loosen the three bolts that secure the air cleaner assembly, then remove the complete assembly as shown.



5) Loosen and remove the two nuts that secure the resonator.



6. NOTE: vehicles equipped with an idle air vent line, disconnect vent line as shown.



7 Loosen the hose clamp at the throttle body and remove the remaining section of the intake assembly.



8. Unhook the throttle cable from the hold down bracket and remove the bracket mounting bolt and bracket from the engine as shown.

NOTE: The mounting bolt will be reused.



9. Install the "Z" bracket onto the engine using the throttle cable bracket mounting bolt removed in step #8 as shown.



10. Install the throttle cable bracket onto the "Z" bracket installed in step #9 with the provided hardware and reattach the throttle cable to the mounting bracket as shown.



11. Loosen and remove the four hex nuts that secure the mass air sensor to the air cleaner assembly then remove the mass air sensor as shown.



12. Assemble the mass air adapter, heat shield, gaskets and the mass air sensor using the hardware provided.



13. Assemble the rubber bumper stud onto the "L" bracket with the provided hardware as shown. NOTE: do not tighten completely.

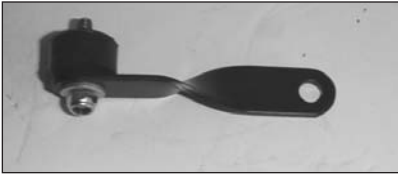

14. Assemble the rubber bumper stud onto the twist bracket with the provided hardware as shown. **NOTE:** do not tighten completely.



15. Install the twist bracket and the "L" bracket assembly onto the heat shield assembly with the provided hardware. Also install the trim seal onto the heat shield as shown.

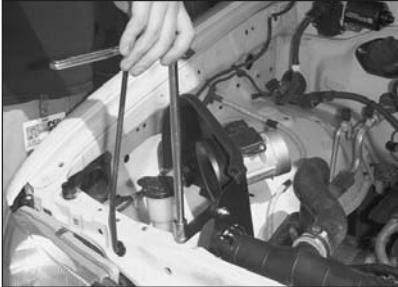

16. Install the heat shield assembly into the vehicle and secure it to the original air box mounting location as shown. Do not tighten completely. **NOTE:** The fender washer and the rubber washer should be mounted between the fender and the "L" bracket.



17. Secure the hump hose #08432 to the mass air sensor end of the tube and hump hose #084044 to the throttle body end of the tube as shown with the hose clamps provided.



18. Install the intake tube onto the throttle body, then install onto the mass air sensor.



19. Vehicles equipped with an idle air vent line, install the 90 deg. fitting into vent line then mark the intake tube where the fitting lines up with tube.

Vehicles that are not equipped with an idle air vent, continue on to step 23.



20. After marking the intake tube, remove from vehicle and drill a 7/8" hole into the intake tube then install the provided grommet as shown.

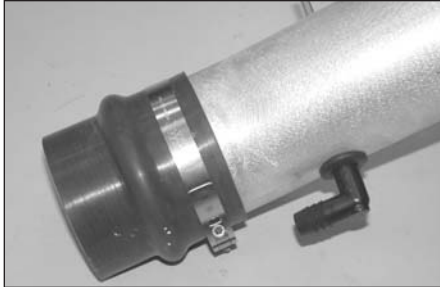

21. Install the 90 degree fitting into the intake tube as shown.



22. Vehicles equipped with the idle air vent line, reconnect vent line as shown.



23. Install the provided silicone hose onto the fuel pressure regulator and connect the other end to the K&N intake tube as shown.

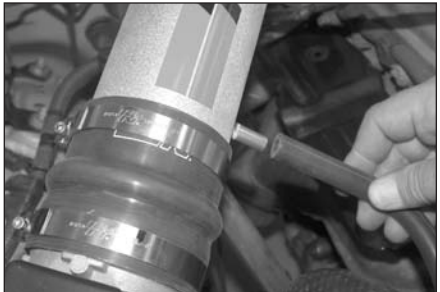

24. Install the provided silicone hose onto the EVAP canister vent and secure the other end onto the K&N intake tube as shown.



25. Install the K&N Filtercharger onto the mass air adapter and secure with the provided hose clamp as shown.



26. Reconnect the mass air sensor electrical connection.



27. Reconnect the negative battery cable and double check to make sure everything is tightened and properly positioned before starting the vehicle.

28. It will be necessary for all intakes to be checked periodically for realignment, clearance and tightening of all connections. Failure to follow the above instructions or proper maintenance may void warranty.

#### ROAD TESTING:

1. Start the engine with the transmission in neutral or park, and the parking brake engaged. Listen for air leaks or odd noises. For air leaks secure hoses and connections. For odd noises, find cause and repair before proceeding. This kit will function identically to the factory system except for being louder and much more responsive.

2. Test drive the vehicle. Listen for odd noises or rattles and fix as necessary.

3. If road test is fine, you can now enjoy the added power and performance from your kit.

4. K&N suggests checking the Filtercharger element periodically for excessive dirt build-up. When the element becomes covered in dirt (or once a year), service it according to the instructions on the Recharger service kit, part number 99-5050 or 99-5000.